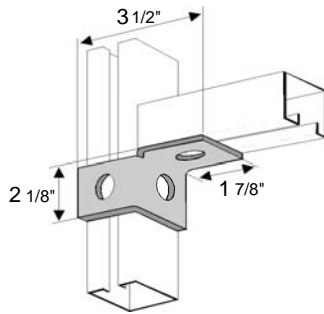
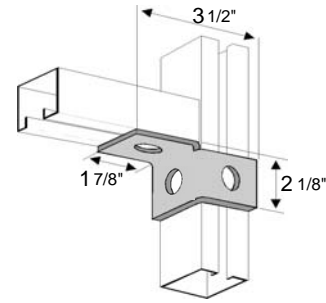
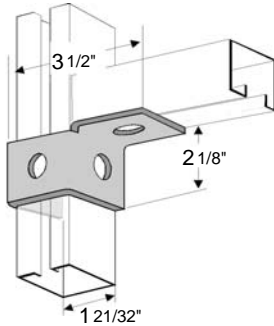

**Three-Hole Single  
Wing Connection**
**WF300**

Wt./C 54 Lbs.  
Std. Pkg. 20 Pcs.

**Three-Hole Single  
Wing Connection**
**WF301**

Wt./C 54 Lbs.  
Std. Pkg. 20 Pcs.

**Four-Hole Single  
Wing Connection**
**WF400**

Wt./C 77 Lbs.  
Std. Pkg. 10 Pcs.

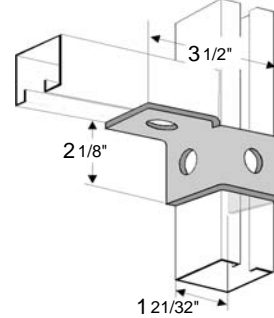
**Four-Hole Single  
Wing Connection**
**WF401**

Wt./C 77 Lbs.  
Std. Pkg. 10 Pcs.

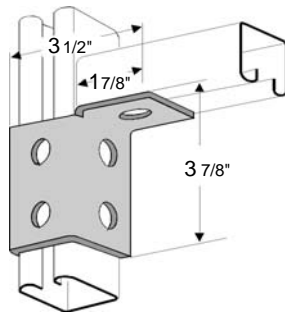
**Five-Hole Single  
Wing Connection**
**WF500**

Wt./C 100 Lbs.  
Std. Pkg. 20 Pcs.

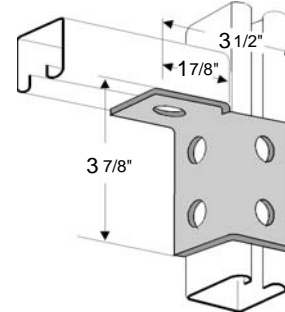
**Five-Hole Single  
Wing Connection**
**WF501**

Wt./C 100 Lbs.  
Std. Pkg. 20 Pcs.

**FITTING SPECIFICATIONS** (*unless noted*) : Hole Size-9/16" Diameter; Hole Spacing-13/16" from end and 1 7/8" on center.  
Width-1 5/8"; Thickness 1/4"

**FINISHES AVAILABLE:** Zinc Plated, Hot-Dipped Galvanized & Stainless Steel

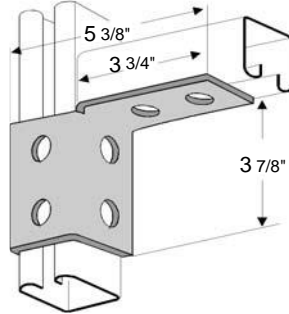
**Six-Hole Single  
Corner Connection**
**WF600**

Wt./C 120 Lbs.  
Std. Pkg. 20 Pcs.

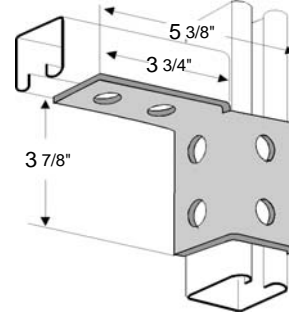
**Six-Hole Single  
Corner Connection**
**WF601**

Wt./C 120 Lbs.  
Std. Pkg. 20 Pcs.

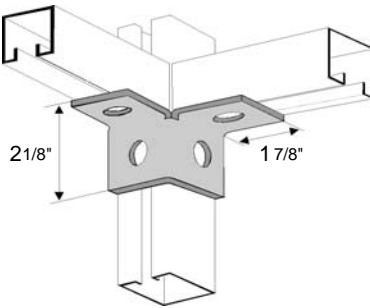
**Four-Hole Double  
Corner Connection**
**WF405**

Wt./C 71 Lbs.  
Std. Pkg. 20 Pcs.

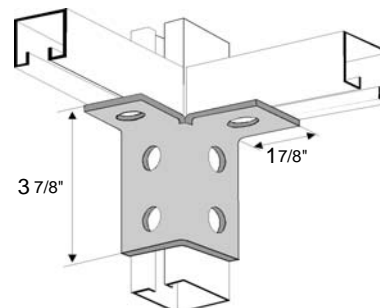
**Six-Hole Double  
Corner Connection**
**WF605**

Wt./C 110 Lbs.  
Std. Pkg. 20 Pcs.

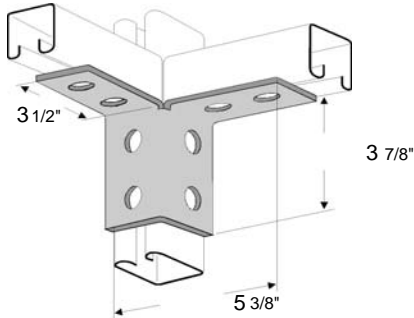
**Eight-Hole Double  
Corner Connection**
**WF805**

Wt./C 152 Lbs.  
Std. Pkg. 10 Pcs.

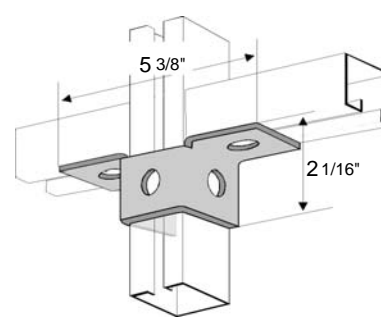
**Five-Hole Double Wing  
Connection**
**WF510**

Wt./C 95 Lbs.  
Std. Pkg. 10 Pcs.

**FITTING SPECIFICATIONS** (*unless noted*) : Hole Size-9/16" Diameter; Hole Spacing-13/16" from end and 1 7/8" on center.  
Width-1 5/8"; Thickness 1/4"

**FINISHES AVAILABLE:** Zinc Plated, Hot-Dipped Galvanized & Stainless Steel

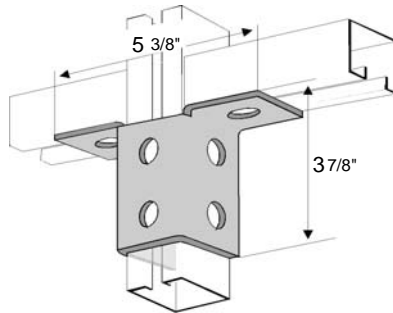
***Eight-Hole Double Wing Connection***
**WF810**

Wt./C 156 Lbs.  
Std. Pkg. 20 Pcs.

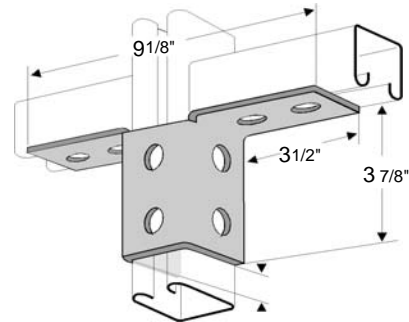
***Ten-Hole Double Wing Connection***
**WF1010**

Wt./C 185 Lbs.  
Std. Pkg. 10 Pcs.

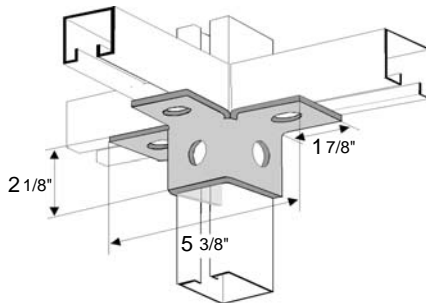
***Six-Hole Triple Wing Connection***
**WF620**

Wt./C 110 Lbs.  
Std. Pkg. 20 Pcs.

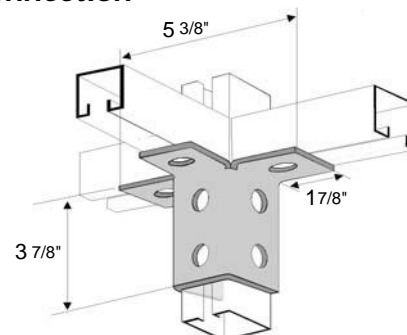
***Nine-Hole Triple Wing Connection***
**WF920**

Wt./C 177 Lbs.  
Std. Pkg. 10 Pcs.

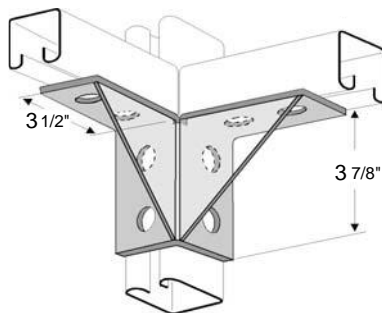
***Eight-Hole Double Corner Gusseted Connection***
**WF830**

Wt./C 196 Lbs.  
Std. Pkg. 5 Pcs.

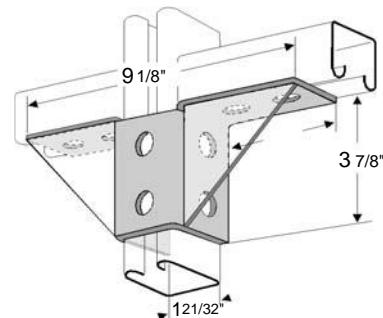
***Ten-Hole Double Wing Gusseted Connection***
**WF1030**

Wt./C 240 Lbs.  
Std. Pkg. 5 Pcs.

**FITTING SPECIFICATIONS** (*unless noted*) : Hole Size-9/16" Diameter; Hole Spacing-13/16" from end and 1 7/8" on center.  
Width-1 5/8"; Thickness 1/4"

**FINISHES AVAILABLE:** Zinc Plated, Hot-Dipped Galvanized & Stainless Steel